

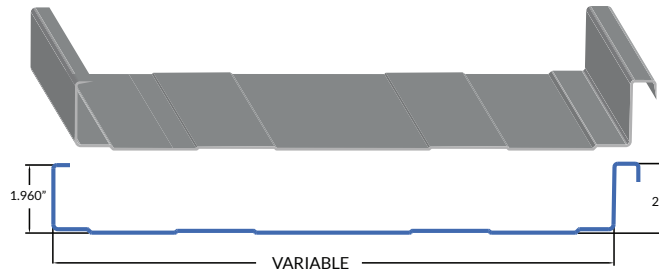

## Mechanical Loc Installation

### 2" Mechanical Loc



### 1.5" Mechanical Loc

also available in 1"

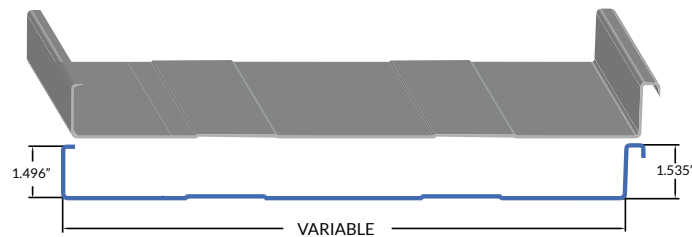

Mechanical Loc is a commercial grade panel that is mechanically seamed and installed with a concealed clip system. This panel is ideal for shallow sloped roofs. Available in 2", 1.5" and 1" seam heights, the Mechanical Loc panel system creates long clean lines with wide spans, provides superior weather-tight protection, and allows for thermal expansion and contraction with a floating clip system. Mechanical Loc is available with minor ribs and comes in variable widths. Mechanical Loc requires on-site seaming.

**Mechanical Loc Trims:** Refer to our 2", 1.5" & 1" Trim Collections for all trim profiles associated with Mechanical Loc Panels

**Installation Drawings:** Basic installation drawings are attached to this document. Specific details and further information may be required as per site requirements.

## Obstacle Removal

Remove downspouts to create a clear workspace for installing the siding. Trees, shrubs and any other objects that could get in the way should also be safely removed. Remove windowsill extensions where necessary.

## Roof Preparation

Ensure that the surface is even. The working surface should be secured with fasteners, and clear of debris such as old paint, putty or caulking buildup. Make sure the house wrap or water barrier is installed according to building codes before installing the panels over top.

## Product Preparation:

Remove the protective film prior to installation. Review panel lengths in reference to the cut sheet.

## Cutting:

Because the underside is flatter, it is recommended that roofing and siding be cut from this side. A power saw, nibbler, snips or profile shear may be used. Be sure to clean metal filings from off the panels to prevent unsightly stains.

## Storage Instructions:

If the panels are not going to be used immediately, they should be stored in a dry well ventilated area. If it is not possible to store the material inside, block up the panels to allow air movement around the packages. Also raise one side of the bundles to ensure positive draining, and use a good quality cover (other than plastic) anchored loosely to protect the material and still allow ventilation. Store away from aggressive substances and any other materials that could contaminate the surface of the panels.

## Application Precautions:

Metal installed with screw fasteners should be fastened onto a solid backing. Avoid installing directly over green, damp or ACQ lumber, porous insulation or other damaging materials. The use of a moisture barrier (such as Ice & Water Shield) is recommended in such situations. Strong chemicals, fertilizers, manure, some soils, and lime may cause premature deterioration. Installation near such materials is not recommended.

## Warning:

Material is slippery and has sharp edges, use extreme caution when handling or installing. Avoid working with sheet metal products on windy days.

## Mechanical Loc Installation Tools Available:

Forma Steel has many tools available for rent to make sure every installation goes as easy as possible. Below are our available tools for installing standing seam panels. Contact our Forma Steel Order Desk to reserve a trailer or tools for your next panel installation.



## SNAPTABLE PRO

The SnapTable is an all-in-one panel preparation system for preparing to install standing seam metal roofing. This tool is designed to perfect and speed-up your panel preparation process while producing factory like cuts.

This complete system is made up of 3 key components: the standing seam notcher, the panel cutter, and the eave and valley hemmer.

The Towable SnapTable Pro provides the highest quality notching, cutting and hemming for any commercial, industrial or residential job. It is equipped to notch, cut & hem your snap lock and standing seam profiles at your eaves, hips and valleys.

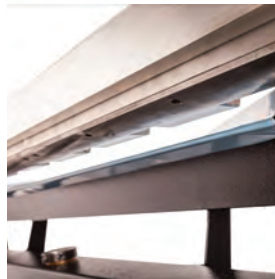
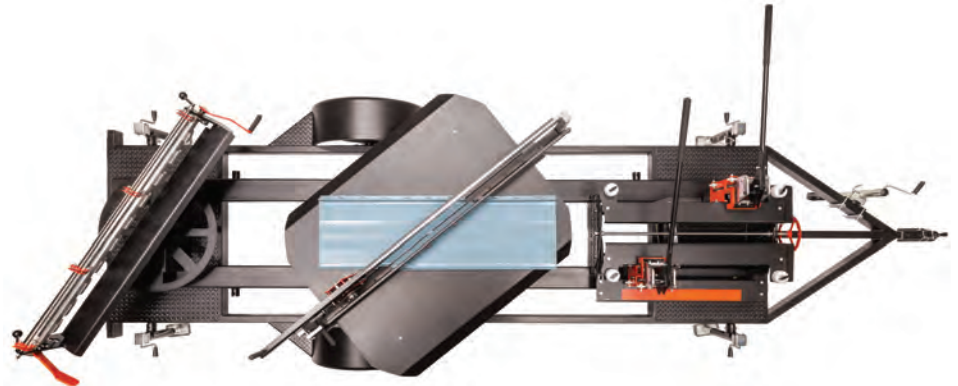

## BIEGETEC DOUBLE SEAM CLOSER



The **Double Seam Closer PVC** tool is for closing both Stages by Double Standing Seam profiles with no surface damage.

## BIEGETEC ACCUSEAMER



The **Accuseamer** is the perfect hand held tool for effortless seaming of single and double lock standing seam and works with a conventional cordless power drill. Seams up to 180ft / minute versus a typical seamer at 35 ft / minute.

FORMA STEEL

(403) 553-3896 | [orders@formasteel.ca](mailto:orders@formasteel.ca) | [formasteel.ca](http://formasteel.ca)

## THERMAL GAP INSTALLATION CHART

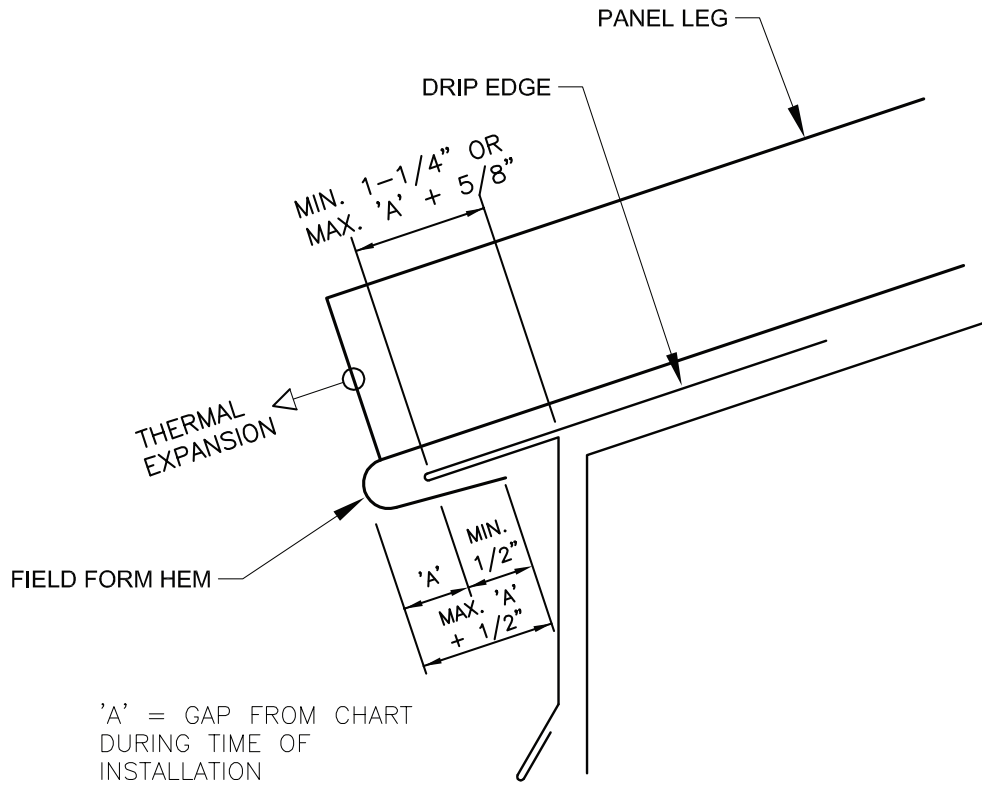

### THERMAL "GAP" INSTALLATION CHART (In inches) - ALUMINUM

For determining proper expansion/contraction gap at panel ends during installation

Distance from fixed point in feet	Material Temperature (Surface Temperature) During Installation					
	Hot		Warm		Cold	
	>100° F		100° to 50° F		<50° F	
10	0.279	1/4	0.139	1/8	0.000	0
20	0.557	9/16	0.279	1/4	0.000	0
30	0.836	13/16	0.418	7/16	0.125	1/8
40	1.115	1 1/8	0.557	9/16	0.125	1/8
50	1.393	1 3/8	0.697	11/16	0.188	3/16
60	1.672	1 11/16	0.836	13/16	0.188	3/16
70	1.950	1 15/16	0.975	1	0.250	1/4
80	2.229	2 1/4	1.115	1 1/8	0.250	1/4
90	2.508	2 1/2	1.254	1 1/4	0.375	3/8
100	2.786	2 13/16	1.393	1 3/8	0.375	3/8

\* Chart based on temperature differential of: 180 degrees F

\* Coefficient of thermal expansion for alum.: 0.0000129

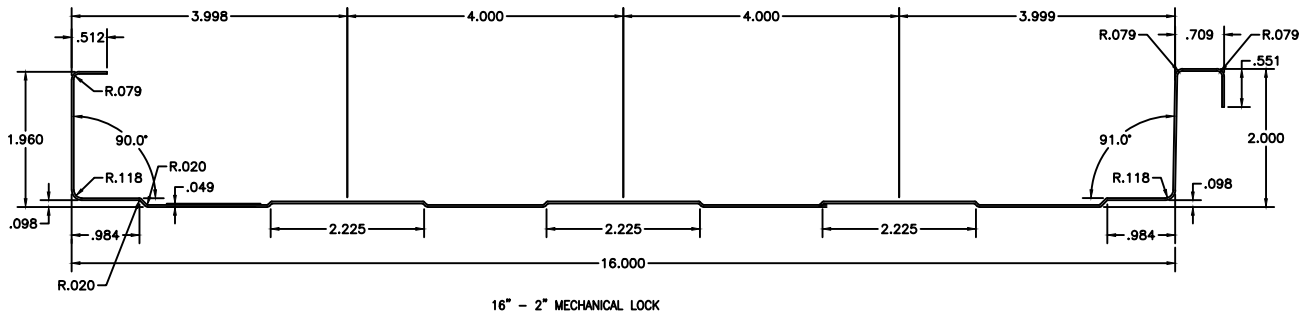

										APP
										CHK
										DRW
										DSN
										DRAWING STATUS
										DATE
										(YY/MM/DD)
										#

**NOTES**

This is a copyright drawing and shall not be reproduced in any form without written permission from Forma Steel

Contractor to check and verify all the dimensions before construction, any errors and omissions shall be reported immediately

Do not scale the drawing

All construction shall be in accordance with latest codes.

**NOTES:**  
 LIGHT GAUGE STEEL CLADDING WITH WIDE FLAT PANS MAY EXHIBIT OIL CANNING WHICH CAN AFFECT THE AESTHETICS OF THE BUILDING DESIGN

OIL CANNING WILL VARY DEPENDING ON THE TIME OF DAY AND ANGLE OF VIEWING AND IS USUALLY MORE NOTICEABLE IN DARKER COLOURS

OIL CANNING WILL ALSO BE MORE PREVALENT IN WIDER PANS AND LONGER SHEET RUNS. BUILDING DESIGNERS AND HOMEOWNERS SHOULD BE AWARE OF THIS AND TAKE INTO CONSIDERATION

OIL CANNING IS NOT A REASON FOR MATERIAL REJECTION

	NAME	SIGNATURE	DATE
OWNER APPROVAL:			
CONTRACTOR APPROVAL:			
CONSULTANT APPROVAL:			
PROJECT	MECHANICAL LOC		
DRAWING	PANEL DRAWING		

DATE  
11-14-2019

SHEET NUMBER  
**SD1**

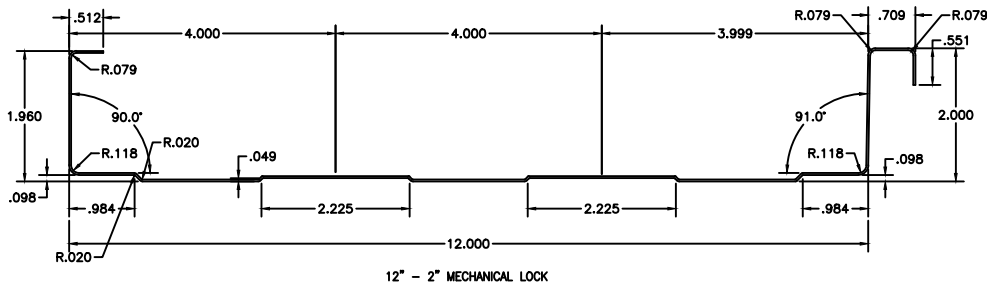

										APP
										CHK
										DRW
										DSN
										DRAWING STATUS
										DATE
										ITV/AMU/001
										#

### NOTES

This is a copyright drawing and shall not be reproduced in any form without written permission from Forma Steel

Contractor to check and verify all the dimensions before construction, any errors and omissions shall be reported immediately

Do not scale the drawing

All construction shall be in accordance with latest codes.

**NOTES:**  
LIGHT GAUGE STEEL CLADDING WITH WIDE FLAT PANS MAY EXHIBIT OIL CANNING WHICH CAN AFFECT THE AESTHETICS OF THE BUILDING DESIGN

OIL CANNING WILL VARY DEPENDING ON THE TIME OF DAY AND ANGLE OF VIEWING AND IS USUALLY MORE NOTICEABLE IN DARKER COLOURS

OIL CANNING WILL ALSO BE MORE PREVALENT IN WIDER PANS AND LONGER SHEET RUNS, BUILDING DESIGNERS AND HOMEOWNERS SHOULD BE AWARE OF THIS AND TAKE INTO CONSIDERATION

OIL CANNING IS NOT A REASON FOR MATERIAL REJECTION

NAME SIGNATURE DATE

OWNER APPROVAL:			
CONTRACTOR APPROVAL:			
CONSULTANT APPROVAL:			

PROJECT	MECHANICAL LOC	DRAWING	PANEL DRAWING
---------	----------------	---------	---------------

DATE  
11-14-2019

SHEET NUMBER  
SD2

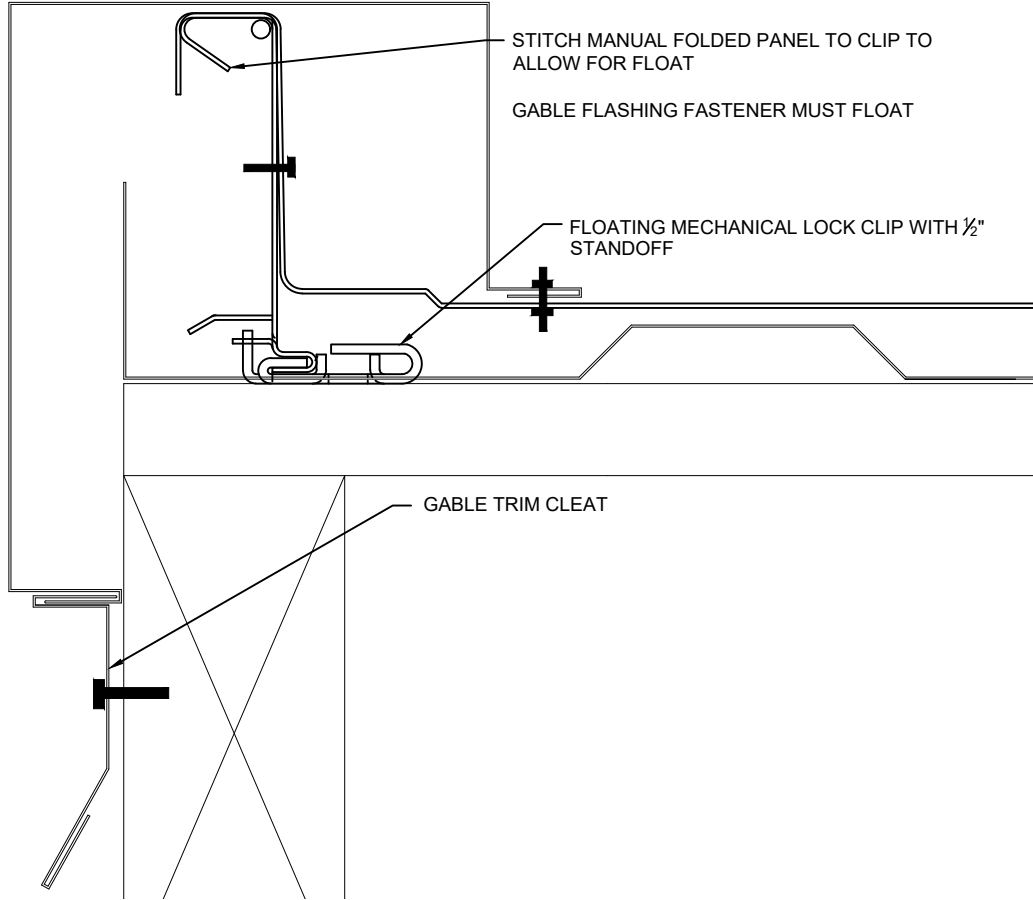

										APP
										CHK
										DRW
										DSN
										DRAWING STATUS
										DATE
										(YY/MM/DD)
										#

**NOTES**

This is a copyright drawing and shall not be reproduced in any form without written permission from Forma Steel

Contractor to check and verify all the dimensions before construction, any errors and omissions shall be reported immediately

Do not scale the drawing

All construction shall be in accordance with latest codes.

	NAME	SIGNATURE	DATE
OWNER APPROVAL:			
CONTRACTOR APPROVAL:			
CONSULTANT APPROVAL:			

PROJECT	<b>MECHANICAL LOC</b>	DRAWING	<b>GABLE STARTER</b>
---------	-----------------------	---------	----------------------

DATE 01-06-20

SHEET NUMBER **SD3**

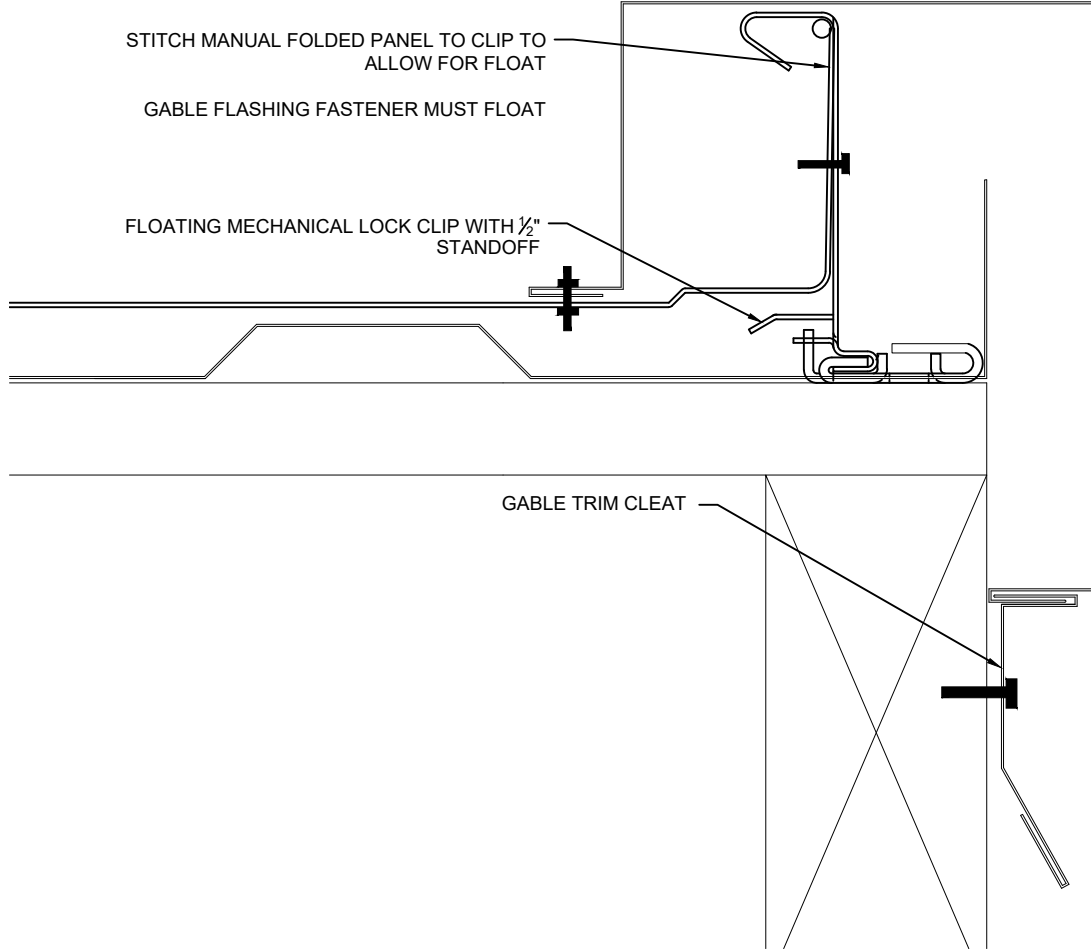

#	DATE (YY/MM/DD)	DRAWING STATUS	DSN	DRW	CHK	APP

**NOTES**

This is a copyright drawing and shall not be reproduced in any form without written permission from Forma Steel

Contractor to check and verify all the dimensions before construction, any errors and omissions shall be reported immediately

Do not scale the drawing

All construction shall be in accordance with latest codes.

	NAME	SIGNATURE	DATE
OWNER APPROVAL:			
CONTRACTOR APPROVAL:			
CONSULTANT APPROVAL:			

PROJECT	<h2>MECHANICAL LOC</h2>	DRAWING	<h2>GABLE FINISH</h2>
---------	-------------------------	---------	-----------------------

DATE  
01-06-20

SHEET NUMBER  
**SD4**



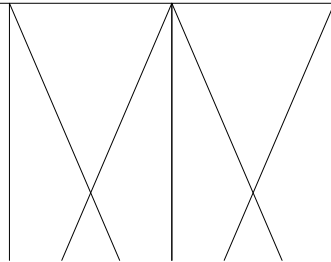
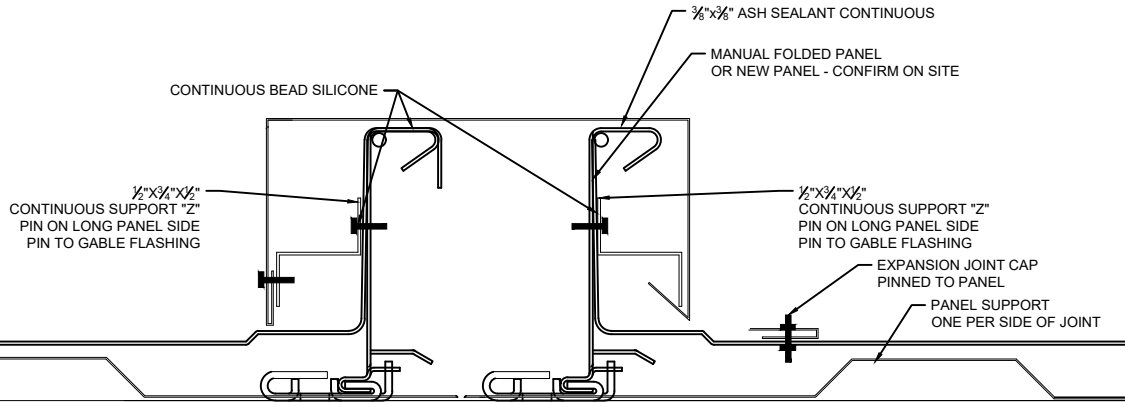

										APP
										CHK
										DRW
										DSN
										DRAWING STATUS
										DATE
										(YY/MM/DD)
										#

### NOTES

This is a copyright drawing and shall not be reproduced in any form without written permission from Forma Steel

Contractor to check and verify all the dimensions before construction, any errors and omissions shall be reported immediately

Do not scale the drawing

All construction shall be in accordance with latest codes.

	NAME	SIGNATURE	DATE
OWNER APPROVAL:			
CONTRACTOR APPROVAL:			
CONSULTANT APPROVAL:			

PROJECT	<b>MECHANICAL LOC</b>	DRAWING	<b>EXPANSION JOINT</b>
---------	-----------------------	---------	------------------------

DATE  
01-06-20

SHEET NUMBER  
**SD5**

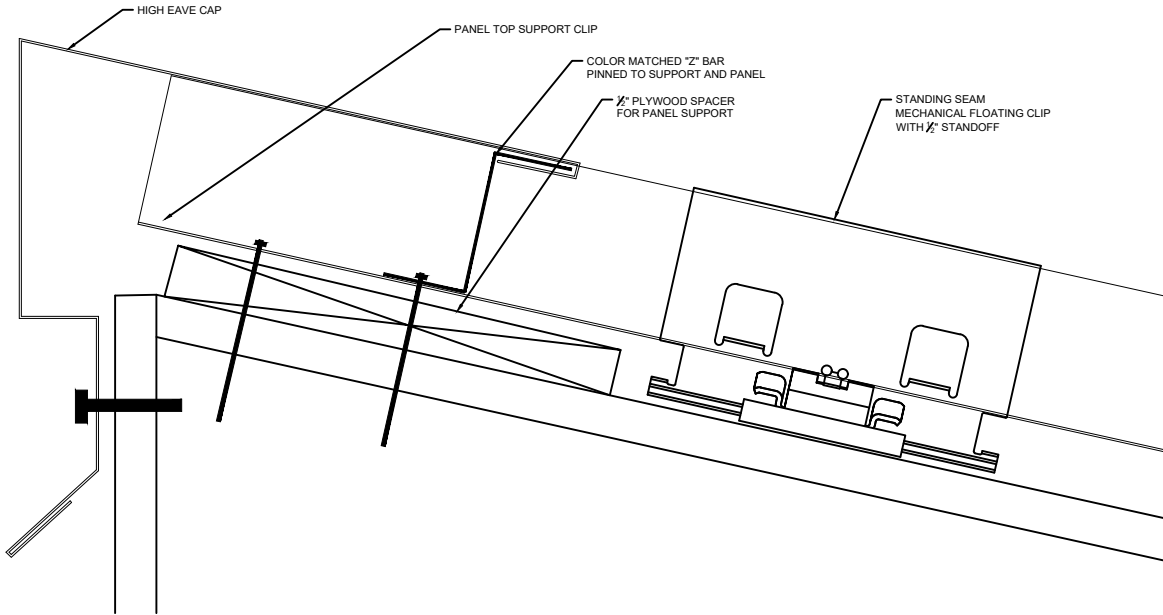

										APP
										CHK
										DRW
										DSN
										DRAWING STATUS
										DATE
										(YY/MM/DD)
										#

### NOTES

This is a copyright drawing and shall not be reproduced in any form without written permission from Forma Steel

Contractor to check and verify all the dimensions before construction, any errors and omissions shall be reported immediately

Do not scale the drawing

All construction shall be in accordance with latest codes.

	NAME	SIGNATURE	DATE
OWNER APPROVAL:			
CONTRACTOR APPROVAL:			
CONSULTANT APPROVAL:			

PROJECT	<b>MECHANICAL LOC</b>	DRAWING	<b>HIGH EAVE</b>
---------	-----------------------	---------	------------------

DATE  
01-06-20

SHEET NUMBER  
**SD6**

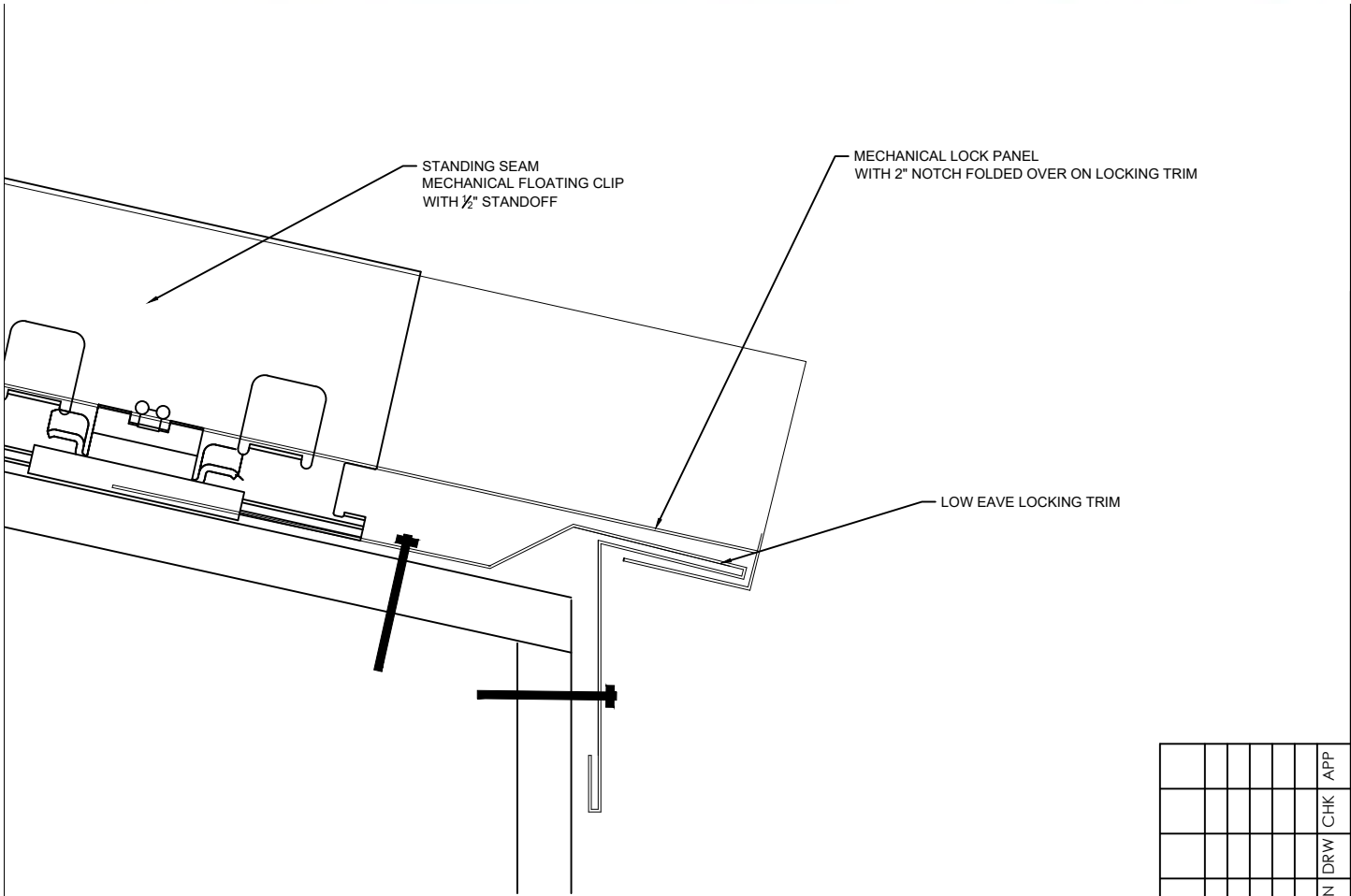

						APP
						CHK
						DRW
						DSN
						DRAWING STATUS
						DATE
						(Y/M/D)
						#

**NOTES**

This is a copyright drawing and shall not be reproduced in any form without written permission from Forma Steel

Contractor to check and verify all the dimensions before construction, any errors and omissions shall be reported immediately

Do not scale the drawing

All construction shall be in accordance with latest codes.

	NAME	SIGNATURE	DATE
OWNER APPROVAL:			
CONTRACTOR APPROVAL:			
CONSULTANT APPROVAL:			

PROJECT	<b>MECHANICAL LOC</b>	DRAWING	<b>LOW EAVE</b>
---------	-----------------------	---------	-----------------

DATE  
01-06-20

SHEET NUMBER  
**SD7**

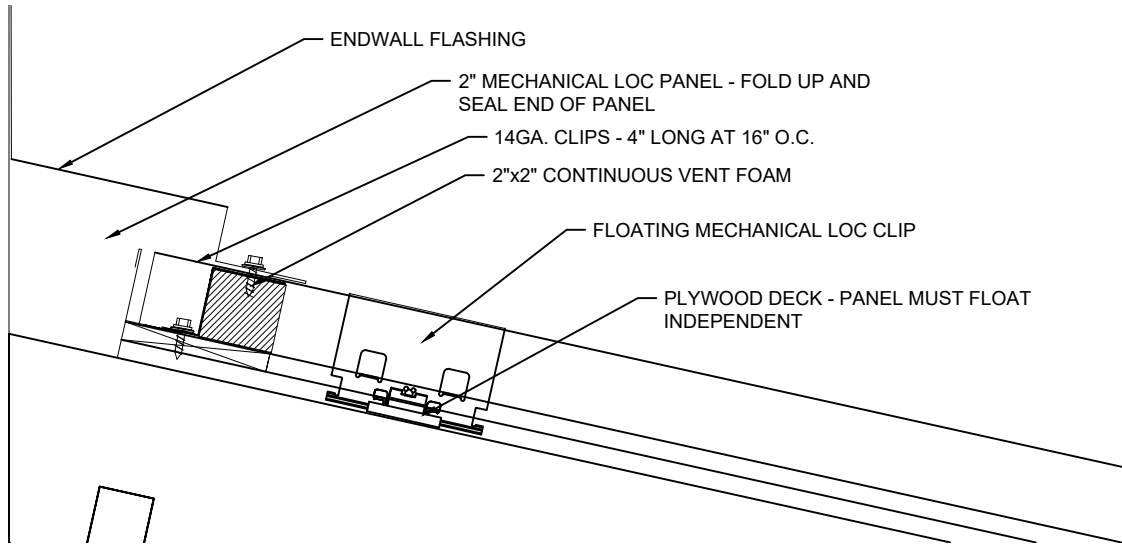

										APP
										CHK
										DRW
										DSN
										DRAWING STATUS
										DATE
										(YY/MM/DD)
										#

**NOTES**

This is a copyright drawing and shall not be reproduced in any form without written permission from Forma Steel

Contractor to check and verify all the dimensions before construction, any errors and omissions shall be reported immediately

Do not scale the drawing

All construction shall be in accordance with latest codes.

	NAME	SIGNATURE	DATE
OWNER APPROVAL:			
CONTRACTOR APPROVAL:			
CONSULTANT APPROVAL:			

PROJECT	<b>MECHANICAL LOC</b>	DRAWING	<b>VENTED HIGH EAVE</b>
---------	-----------------------	---------	-------------------------

DATE: 01-06-20

SHEET NUMBER: **SD8**

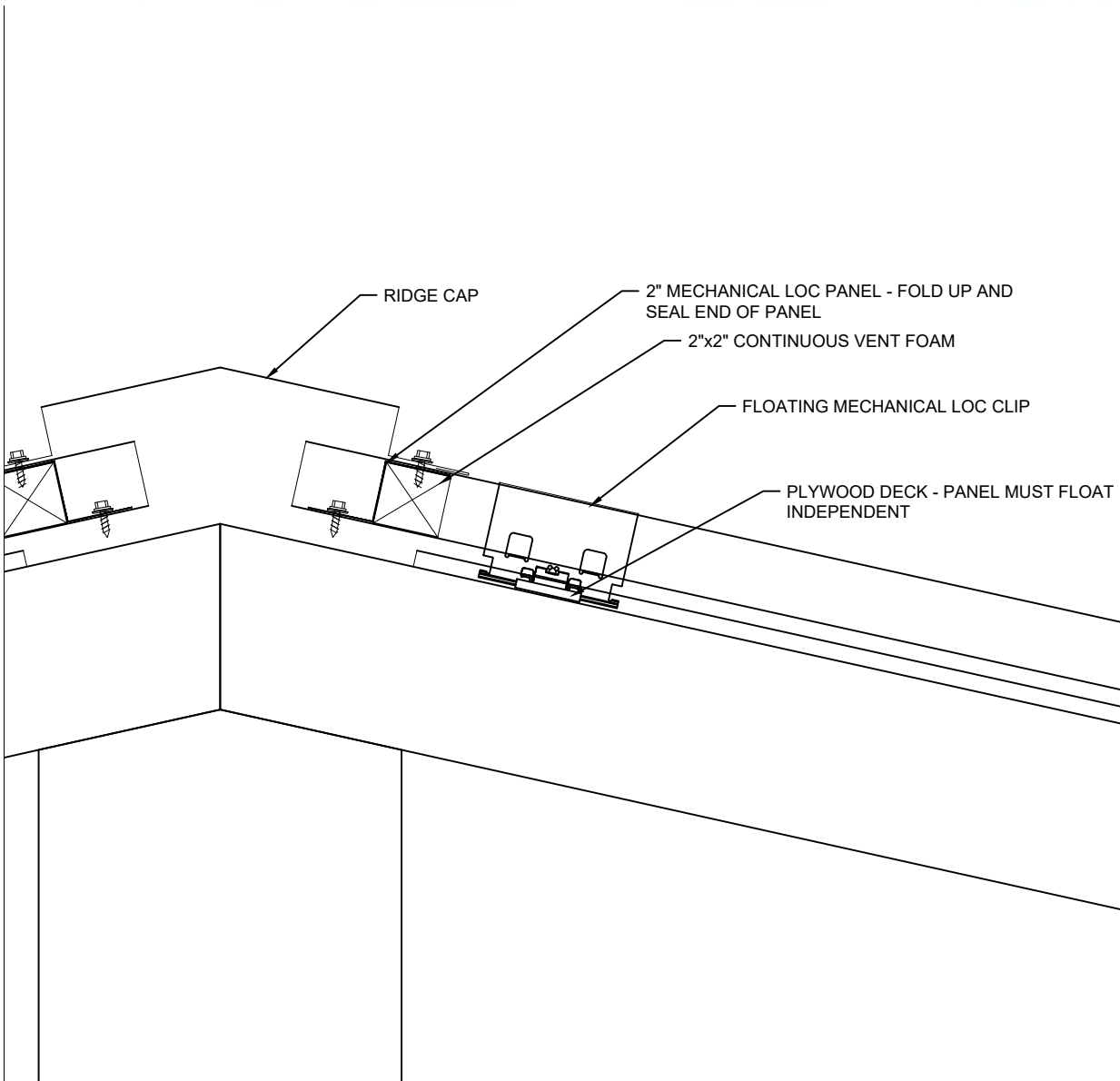

											APP
											CHK
											DRW
											DSN
											DRAWING STATUS
											DATE
											#

**NOTES**

This is a copyright drawing and shall not be reproduced in any form without written permission from Forma Steel

Contractor to check and verify all the dimensions before construction, any errors and omissions shall be reported immediately

Do not scale the drawing

All construction shall be in accordance with latest codes.

	NAME	SIGNATURE	DATE
OWNER APPROVAL:			
CONTRACTOR APPROVAL:			
CONSULTANT APPROVAL:			

PROJECT: **MECHANICAL LOC**      DRAWING: **VENTED RIDGE**

DATE: 01-06-20

SHEET NUMBER: **SD9**

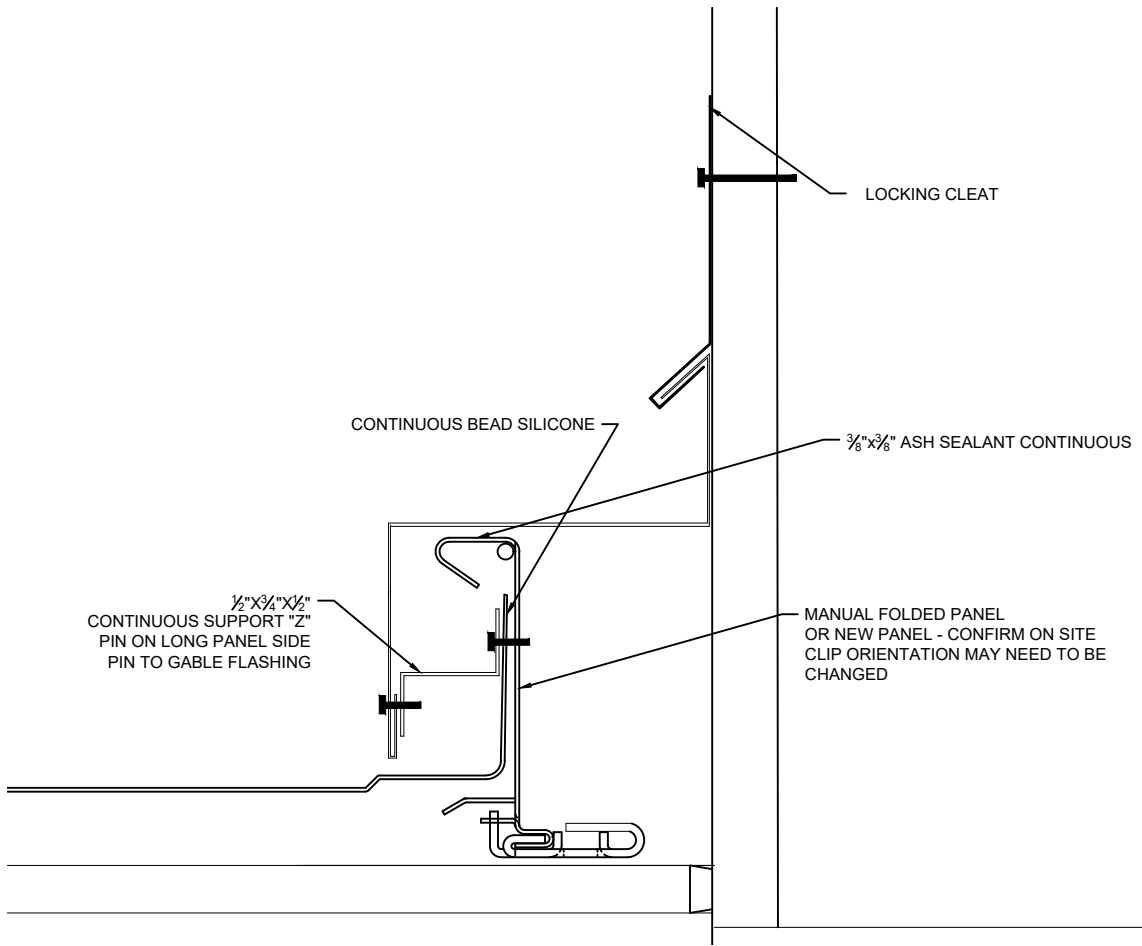

DATE	DRAWING STATUS	DSN	DRW	CHK	APP

**NOTES**

This is a copyright drawing and shall not be reproduced in any form without written permission from Forma Steel

Contractor to check and verify all the dimensions before construction, any errors and omissions shall be reported immediately

Do not scale the drawing

All construction shall be in accordance with latest codes.

	NAME	SIGNATURE	DATE
OWNER APPROVAL:			
CONTRACTOR APPROVAL:			
CONSULTANT APPROVAL:			

PROJECT	<b>MECHANICAL LOC</b>	DRAWING	<b>SIDE WALL DETAIL</b>
---------	-----------------------	---------	-------------------------

DATE  
01-06-20

SHEET NUMBER  
**SD10**



HIGH EAVE WITH NO NOTCH

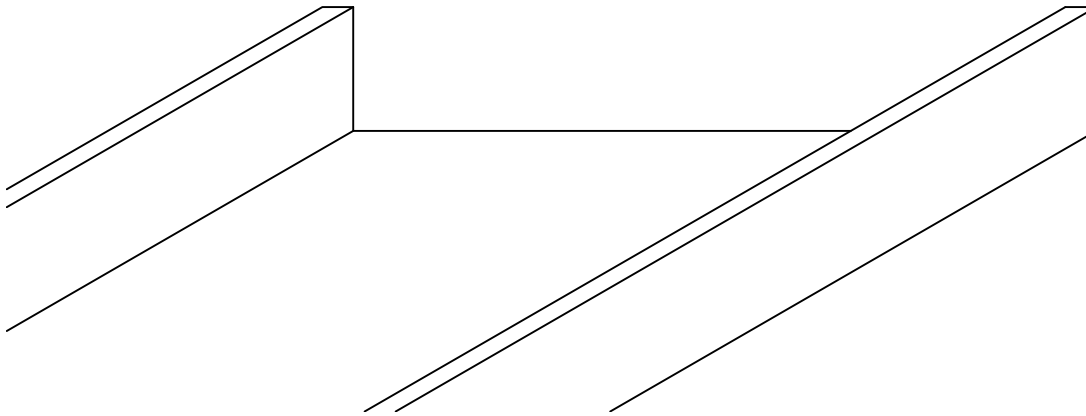

LOW EAVE WITH 2" NOTCH

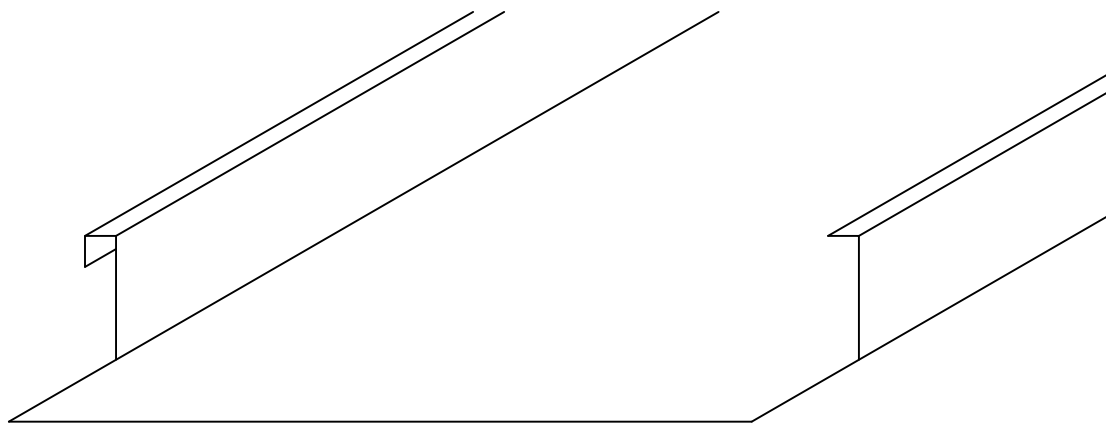

										APP
										CHK
										DRW
										DSN
										DRAWING STATUS
										DATE
										(YY/MM/DD)
										#

**NOTES**

This is a copyright drawing and shall not be reproduced in any form without written permission from Forma Steel

Contractor to check and verify all the dimensions before construction, any errors and omissions shall be reported immediately

Do not scale the drawing

All construction shall be in accordance with latest codes.

	NAME	SIGNATURE	DATE
OWNER APPROVAL:			
CONTRACTOR APPROVAL:			
CONSULTANT APPROVAL:			

PROJECT	<b>MECHANICAL LOC</b>	DRAWING	<b>PANEL NOTCH</b>
---------	-----------------------	---------	--------------------

DATE	01-06-20	SHEET NUMBER	<b>SD11</b>
------	----------	--------------	-------------